

# How to install your Roller Blind

#N300544

**VENETA**<sup>®</sup>  
VENETABLINDS.COM.AU

## Required Tools

measuring  
tape

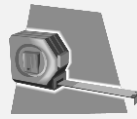

drill with  
2mm bit



phillips bit or  
screwdriver



pencil

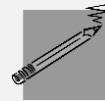

knife



## Included Hardware

The hardware can be found in the small plastic bag included with your blind.



Chain side  
Installation Bracket  
including cover



Lock side  
Installation Bracket  
including cover



Child Safety  
Guide



Screws for Wood,  
Metal or Wall  
Anchors



Wall Anchors for  
Brick or Cement  
using a 6mm bit

## Feedback?

Please write a review on our website letting us know your experience with Veneta Blinds

[www.venetablinds.com.au](http://www.venetablinds.com.au)

## 1 Installation Brackets

### Installing inside the window frame...

- Take note to position brackets away from window handles and other obstructions allowing the blind to operate freely. Often the bracket will be flush with the front of window frame.
- Slide bracket covers onto brackets, if not already done.
- Position Chain Side bracket inside window frame at the top corner and mark where the 2 screws will go.
- Take note of the measurement to front of window frame.
- Position Lock Side bracket inside window frame at the opposite top corner, at the same measurement to front of window frame and mark where the screws will go.
- We recommend drilling pilot holes for the screws using a 2mm bit.
- Fix the brackets into position using 2 screws for each bracket.



### Installing outside the window frame...

- Position the Chain Side bracket at the top corner of where the blind will sit and mark where the 2 screws will go.
- Position the Lock Side bracket at the opposite top corner of where the blind will sit and mark where the 2 screws will go.
- We recommend using a spirit level to align brackets if not on architrave.
- We recommend drilling pilot holes for the screws using a 2mm bit.
- Fix the brackets into position using 2 screws for each bracket.

## 2 Install Blind

- With the blind still rolled up...
- Slip the chain end of blind into the Chain Side bracket, ensuring the chain hangs freely straight down.
- Slide the other end of blind into the Lock Side bracket and the spring loaded knob will click into place.



Installation  
continued...

## 3 Child Safety Guide

- Position the Child Safety Guide on the wall where the chain is at a slight tension but still allowing for smooth operation, and mark where the screw will go.
- We recommend drilling pilot holes for the screws using a 2mm bit.
- Fix the Child Safety Guide into position using 1 screw.



**WARNING**

### ALL WINDOW COVERINGS WITH CORD OR CHAIN

To avoid creating a possible strangulation hazard for children, the corded internal window covering must be installed in such a way that a loose cord cannot form a loop 220mm or longer at a height of less than 1600mm above floor level.

- A cord/chain guide may be installed lower than 1600mm above floor level if the cord/chain is sufficiently secured or tensioned to prevent a loop 220mm or longer from being formed.
- If a cord/chain guide is installed lower than 1600mm above floor level it must be designed to prevent a child from being able to remove the cord.
- If a cleat is used to secure the cord, it must be installed at least 1600mm above floor level because a child is capable of unwinding a cord from a cleat. For more information, please visit our website at [www.venetablinds.com.au/child-safety](http://www.venetablinds.com.au/child-safety).

## Great Job... Enjoy your new Veneta Blinds!

### Operating your Blind

- To operate your new Roller blind, simply pull the chain down at the front to raise the blind or pull the chain down at the back to lower the blind.

### Maintaining your Blind

## 1 Dusting

- Dust can be removed using a feather duster or vacuum with brush attachment on low suction.

## 2 Spot Cleaning

- Use a warm damp cloth or a mild detergent for tougher stains.
- Dab the affected area, but do not rub the fabric. Finish with just a warm damp cloth.
- Allow the fabric to dry in the lowered position.

## 3 Fabric Rolls off to one side

- If the fabric starts to gather at one side or rolls up unevenly you will need to re-align the fabric.
- To do this, lower the fabric completely down.
- Then as you roll the fabric back up, apply slight tension to the side you want the roll to go.
- Be sure not to let the fabric gather or lump around the tube.
- Repeat this process a few times over.
- If this does not fix the problem, please contact our Customer Service team on 1300 836 382.

Need HELP?

Customer Service

1300 836 382