

Required Tools

measuring
tape

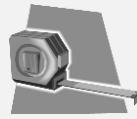

drill with
2mm bit



phillips bit or
screwdriver



pencil

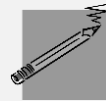

knife



Included Hardware

The hardware can be found in the small plastic bag included with your blind.



Pin Side
Installation Bracket



Motor Side
Installation Bracket



Battery Clip



Screws for Wood,
Metal or Wall
Plugs



Wall Plugs for
Brick or Cement
using a 6mm bit

1 Installation Brackets

Installing inside the window frame...

- Take note to position brackets away from window handles and other obstructions allowing the blind to operate freely. Often the bracket will be flush with the front of window frame.
- Slide bracket covers onto brackets, if not already done.
- Position Motor Side bracket inside window frame at the top corner and mark where the 2 screws will go.
- Take note of the measurement from bracket to the front of window frame.
- Position Pin Side bracket inside window frame at the opposite top corner, at the same measurement to the front of window frame and mark where the screws will go.
- We recommend drilling pilot holes for the screws using a 2mm bit.
- Fix the brackets into position using 2 screws for each bracket.

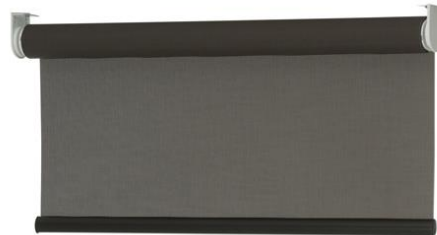

Installing outside the window frame...

- Position the Motor Side bracket at the top corner of where the blind will sit and mark where the 2 screws will go (often edge of architrave).
- Position the Pin Side bracket at the opposite top corner of where the blind will sit and mark where the 2 screws will go.
- We recommend using a spirit level to align brackets if not on architrave.
- We recommend drilling pilot holes for the screws using a 2mm bit.
- Fix the brackets into position using 2 screws for each bracket.

Feedback?

We would love to know how you went with your installation...

Please write a review on our website letting us know your experience with Veneta Blinds

www.venetablinds.com.au

2 Install Blind

- With the blind still rolled up...
- Slip the Motor end of blind into the Motor Side bracket.
- Slide the other end of blind into the Pin Side bracket, and the spring loaded pin will click into place.



Installation continued...

3 Install Battery Tube

- With the blind still rolled up...
- Attach the battery clips to the window frame: Position the battery clips evenly along the battery tube, facing the window and within reach of the motor cord using one 25mm screw for each clip.
- Clip the battery tube to the battery clips.
- Optional: place the rubber rings onto the battery tube for a tighter fit inside
- Connect the battery tube to the motor of the blind.

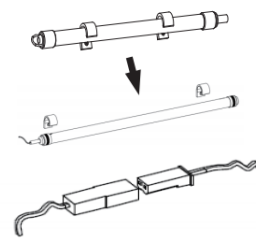

Operating your Blind

- To operate your new Motorised Roller blind, press briefly the UP or DOWN button
- To stop the shade, press the MY button.

Extra Remote Settings

The Upper and Lower limits of the blind have been programmed, however the limits can be changed.

1 Recording My Position

- My Position lets you program a preferred position of your blinds so that you can access that favourite position every time.
- To set the MY Position, move the shade to the desired position with the UP and DOWN buttons then press the MY button until the shade jogs.
- To delete the MY Position, press the MY button to move to this position and press the MY button until the shade jogs.
- To move the shade to the MY position, briefly press the MY button.

2 Changing the Upper and Lower Limits

Changing the UP Limit

- Press the UP button to move the shade to the limit to be readjusted.
- Press and hold the UP and DOWN buttons simultaneously until the shade jogs.
- Press and hold the UP or DOWN button to move the shade to the new desired position.
- To confirm the new limit press and hold the MY button until the shade jogs.

Changing the DOWN Limit

- Press the DOWN button to move the shade to the limit to be readjusted.
- Press and hold the UP and DOWN buttons simultaneously until the shade jogs.
- Press and hold the UP or DOWN button to move the shade to the new desired position.
- To confirm the new limit press and hold the MY button until the shade jogs.

Need HELP?

Call our
Customer Service team
for assistance

1300 836 382

Maintaining your Blind

1 Dusting

- Dust can be removed using a feather duster or vacuum with brush attachment on low suction.

2 Spot Cleaning

- Use a warm damp cloth or a mild detergent for tougher stains.
- Dab the affected area, but do not rub the fabric. Finish with just a warm damp cloth.
- Allow the fabric to dry in the lowered position.

100% Child Safe

This product has no
cord or chain
and is
100% Child Safe