

#N300545

Required Tools

measuring
tape

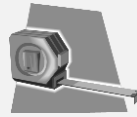

drill with
2mm bit



phillips bit or
screwdriver



pencil



knife



Included Hardware

The hardware can be found in the small plastic bag included with your blind.



Cassette



Side Channel
(2 x 2 pieces)



Side Guide
Ear



Locking Clip



Child Safety
Guide



Screws for Wood,
Metal or Wall
Anchors

Wall Anchors for
Brick or Cement
using a 6mm bit

Need HELP?

Customer Service

1300 836 382

1 Prepare Cassette

- Remove the end caps away by pulling away from the blind as shown.
- Remove the front cover of the Cassette as per image pulling out then up. Note: open the non cord end first.
- With the blind still rolled up, spin the cog upwards at the opposite side of the chain, until the blind pops out.
- Remove blind from Cassette by pulling the cog end towards you and sliding away from the chain end of the blind.
- Gently remove the chain from the chain holder.
- Place the Cassette in position and drill 2 holes through the Cassette and into the wall or window frame, ensuring that the screws are evenly spaced apart.
- We recommend drilling pilot holes for the screws using a 2mm bit.
- Slip the chain end of the blind into the Chain Side bracket.
- Push the non chain end into the bracket.
- Place the cord back through the chain holder.
- Install the Side Guide Ears into the inside of the cassette.
- Attach Cassette front cover by snapping back into place.
- Attach end caps back onto the cassette.

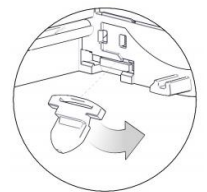

2 Install Side Channels

- Remove screws from the removeable side of the channel. Snap the two pieces apart.
- Place the side channel with the plastic caps into position on the wall, fixing the rail to the Side Guide Ear for correct position.
- NOTE: lift out fabric and bottom rail to insert fabric into side channels.
- Fix side channels to the wall. Ensure side guides are vertical and parallel using a spirit level.
- Snap Locking Clips onto unattached side channel
- Insert Side Channel into fixed side channel as shown in diagram.
- Using a flat head screw driver, lock the Locking clips into position.
- Repeat for other side.

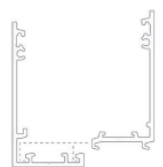

LOCKED POSITION

Installation continued...

3 Child Safety Guide



WARNING

ALL WINDOW COVERINGS WITH CORD OR CHAIN

To avoid creating a possible strangulation hazard for children, the corded internal window covering must be installed in such a way that a loose cord cannot form a loop 220mm or longer at a height of less than 1600mm above floor level.

- A cord/chain guide may be installed lower than 1600mm above floor level if the cord/chain is sufficiently secured or tensioned to prevent a loop 220mm or longer from being formed.
- If a cord/chain guide is installed lower than 1600mm above floor level it must be designed to prevent a child from being able to remove the cord.
- If a cleat is used to secure the cord, it must be installed at least 1600mm above floor level because a child is capable of unwinding a cord from a cleat. For more information, please visit our website at www.venetablinds.com.au/child-safety.

- Position the Child Safety Guide on the wall where the chain is at a slight tension but still allowing for smooth operation, and mark where the screw will go.
- We recommend drilling pilot holes for the screws using a 2mm bit.
- Fix the Child Safety Guide into position using 1 screw.

Great Job... Enjoy your new Veneta Blinds!

Operating your Blind

- To operate your new Roller blind, simply pull the chain down at the front to raise the blind or pull the chain down at the back to lower the blind.

Feedback?

Please write a review on our website letting us know your experience with Veneta Blinds

www.venetablinds.com.au